

# Articulating Arm VESA Mount VSM-AR1 & VSM-AR2

## Form E-426

### Caution!

This unit is designed for wall installation. Qualified personnel using the appropriate fasteners should mount this unit. The surface to which this unit is mounted must be capable of supporting a static load of four times the combined weight of the monitor and mount. Do not attach to plaster, drywall, or paneling alone.

### Tools Required

7/16" and 9/16" wrenches, Phillips head screw driver.

### Procedures

Use the chart below to select the proper fastener kit for your specific wall application. Determine the location of the mounting hardware and follow the directions for installation.

Wall construction	Fastener Kit Model Number	Hole size
Concrete	A101 (3/8" cap screws & hollow set drop in anchors)	5/8"
Wood stud	A105 (3/8" lag screws)	3/16"
Metal stud or Concrete block	A109 (3/8" cap screws & togglers)	3/4"

### VSM-AR1 & VSM-AR2 INSTALLATION

1. Remove contents from carton.
2. Mount the Wall Plate to the wall in the desired location. See Figure 1.
3. (Optional) The Swing Channel can be removed and reassembled to swing in the opposite direction. It is recommended to flip the Tilt Plate as well.
4. Attach the Flat Panel Display unit using the metric fasteners provided by partially inserting screws into the top two VESA threaded fastener locations of the Flat Panel Display. Use the keyhole notches in the Tilt Plate to hold the Flat Panel Display while inserting the bottom two screws of the VESA pattern. Tighten all screws.
5. Adjust the screws and nuts at all of the joints for the weight of your particular Flat Panel Display unit. Check fasteners periodically.
6. (Optional) Adhere the cable management clips, which are provided, to the mount as needed to restrain the electrical cords and cables.

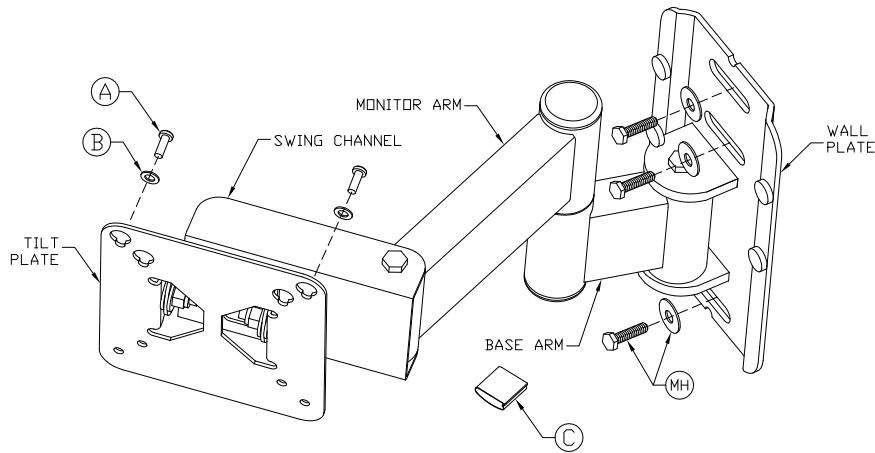

Figure 1

	Qty	Description
A	4	Screw, SHCS, M4 X 12mm, Zinc
B	4	Washer, Flat, 5mm
C	4	Adhesive clip

\*MH – To be provided by installer

### DA-LITE SCREEN COMPANY, INC.

3100 North Detroit Street  
 Post Office Box 137  
 Warsaw, IN 46581-0137  
 Phone: 574/267-8101  
 800-622-3737  
 fax: 574/267-7804  
<http://www.da-lite.com>  
 e-mail: info@da-lite.com