



DA-LITE SCREEN COMPANY, INC.
 3100 North Detroit Street
 Post Office Box 137
 Warsaw, IN 46581-0137
 Phone: 574.267.8101
 Toll Free: 800.622.3737
 Fax: 574.267.7804
 www.da-lite.com
 info@da-lite.com

Coupling Plate Accessory Kit A304 and A305

Form E-379
 Rev. 11 / 08

Caution: This product is designed for ceiling installation only. Qualified personnel using the appropriate fasteners should mount the Coupling Plate. The surface to which this unit is mounted must be capable of supporting a static load of four times the combined weight of the projector and mount. Do not attach to plaster or drywall alone.

Required Tools:

- 5/16" hex driver
- Drill motor
- 9/16" wrench

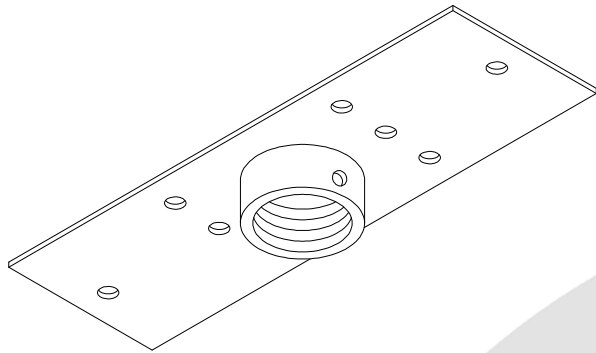

Procedure

1. Remove contents from carton and examine for damaged or missing parts.

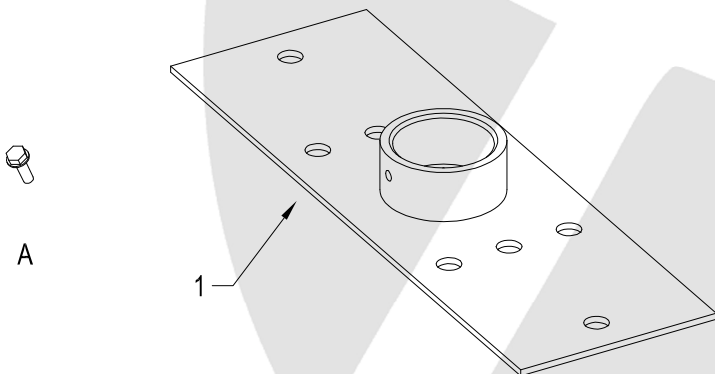

ITEM	DESCRIPTION	QTY
1	COUPLING PLATE WELDMENT PACKAGE SET	1
A	SCREW, SELF DRILLING #10	2

2. Due to the various ceiling constructions, careful consideration should be given to the selection and use of fasteners. For a listing of available fastener kits refer to the chart below.

Ceiling Construction	Fastener Kit Model Number	Hole Size
Concrete	A101 (3/8" cap screws and hollow set drop-in anchors)	5/8"
Wood Joist	A105 (3/8" lag screws)	3/16"
Metal Joist	A111 (3/8" cap screws and nuts)	7/16"

3. Secure the Coupling Plate to the structural part of the ceiling with suitable fasteners. See Figure 1.
4. Insert a 1-1/2" NPT threaded pipe (not included) securely into the coupling. Screw a #10 self-drilling screw into the threaded pipe through the existing hole in the coupling to prevent removal of the pipe.

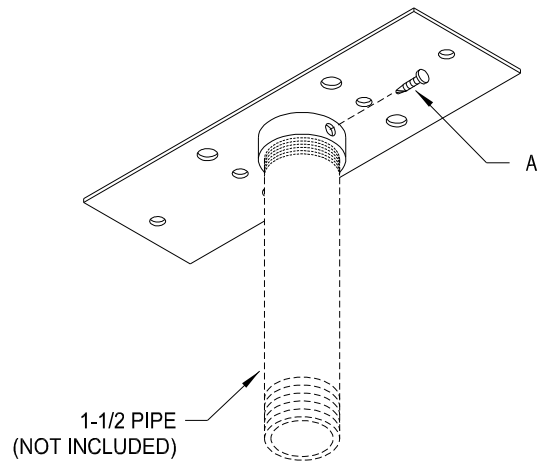

Figure 1