

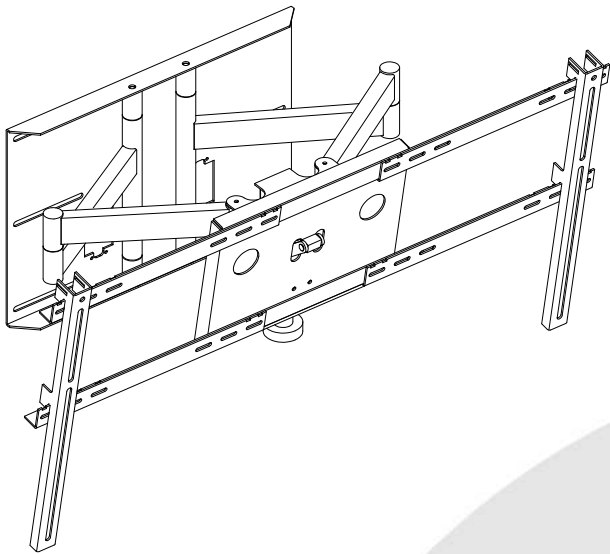

DA-LITE SCREEN COMPANY, INC.  
3100 North Detroit Street  
Post Office Box 137  
Warsaw, IN 46581-0137  
Phone: 574.267.8101  
Toll Free: 800.622.3737  
Fax: 574.267.7804  
www.da-lite.com  
info@da-lite.com

## Plasma Wall Mount Articulating Arm PWM-AR1

Form E-446  
Rev. 5 / 10



**Caution:** This product is designed for wall installation only. Qualified personnel using the appropriate fasteners should mount the Articulating Arm. The surface to which this unit is mounted must be capable of supporting a static load of four times the combined weight of the audio/visual device and mount. Do not attach to plaster, paneling or drywall alone.

### Required Tools:

- 7/16" wrench
- 9/16" wrench

### Procedure

1. Remove contents from carton and examine for damaged or missing parts.

| ITEM | DESCRIPTION              |
|------|--------------------------|
| 1    | ZEE-BAR, 38"             |
| 2    | ZEE-BAR PLATE ASSEMBLY   |
| 3    | ARM ASSEMBLY             |
| 4    | WALL PLATE               |
| 5    | ZEE-BAR EXTENSION        |
| 6    | HANGER, 22"              |
| 7    | BEARING                  |
|      | PACKAGE SET              |
| A    | HOLD DOWN, LH            |
| B    | HOLD DOWN, RH            |
| C    | NUT, HEX 1/4"-20         |
| D    | NUT, HEX 1/4"-20 NYLON I |
| E    | SCREW, BHSCS 1/4"-20 X   |
| F    | SCREW, HHCS 1/4"-20 X 3  |
| G    | SCREW, HHCS 3/8"-16 X 1  |
| H    | WASHER, FLAT 1/4" PLAS   |
| P    | WASHER, FLAT 1/4"        |
| J    | WRENCH, ALLEN 5/32"      |
|      | PACKAGE SET              |
| K    | SCREW, SHCS              |
| L    | WASHER, FLAT             |
| M    | WRENCH, ALLE             |
|      | PACKAGE SET              |
| N    | SCREW, SHCS              |
| P    | WASHER, FLAT             |
| Q    | WRENCH, ALLE             |
|      | PACKAGE SET              |
| R    | SCREW, SHCS              |
| S    | SCREW, SHCS              |
| T    | WASHER, FLAT             |
| U    | WASHER, FLAT             |
| V    | WRENCH, ALLE             |
| W    | WRENCH, ALLE             |

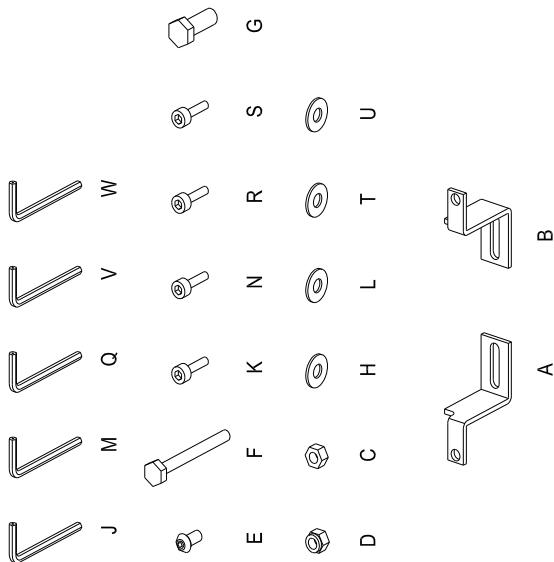
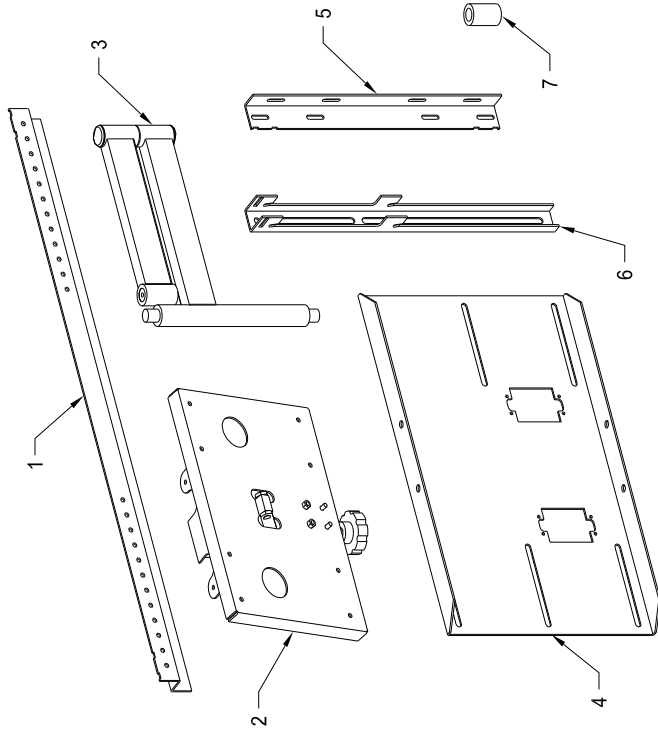

2. Due to the various wall constructions, careful consideration should be given to the selection and use of fasteners. For a listing of available fastener kits refer to the chart below.

| Wall Construction            | Fastener Kit Model Number                           | Hole Size |
|------------------------------|---|-----------|
| Concrete                     | A101 (3/8" cap screws & hollow set drop-in anchors) | 5/8"      |
| Wood Stud                    | A105 (3/8" lag screws)                              | 3/16"     |
| Metal Stud or Concrete Block | A109 (3/8" cap screws & anchors)                    | 3/4"      |

3. Mount the Wall Plate to the wall. See Figure 1.

Figure 1

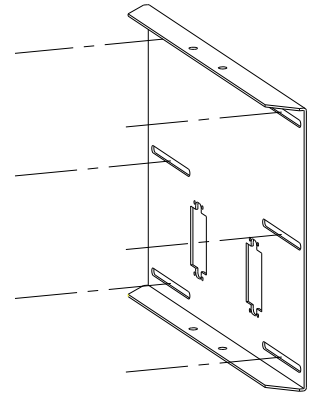

4. Insert a Plastic Washer into a Bearing. See Figure 2. Place Bearing, with Plastic Washer, on bottom pivot of an Arm Assembly. Place a Bearing, without a Plastic Washer, on top pivot of an Arm Assembly.

5. Attach Arm Assembly and Bearings into Wall Plate.

6. Repeat step 4 and 5 with other Arm Assembly.

Figure 2

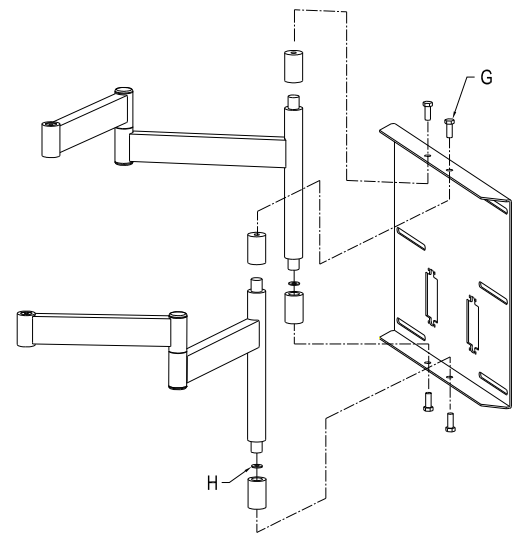

7. Attach Zee-Bar Plate Assembly to the Arm Assemblies utilizing four Plastic Washers. See Figure 3.

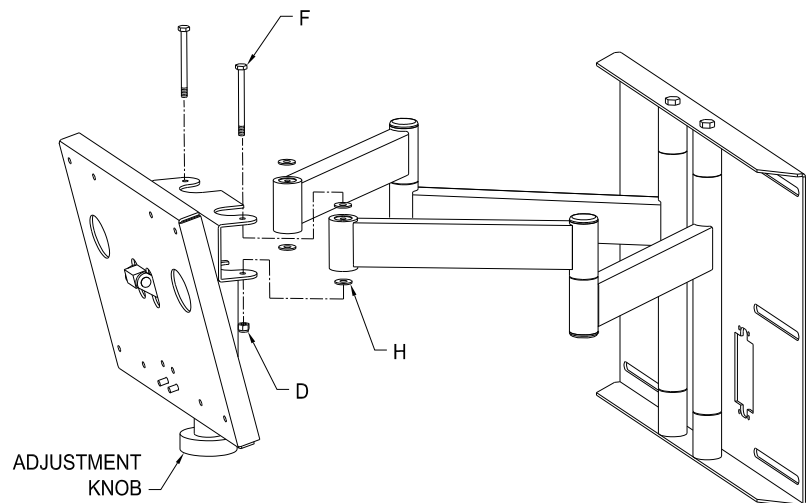

Figure 3

8. Attach Zee-Bars to Zee-Bar Plate Assembly. See Figure 4.
9. Attach the Zee-Bar Extensions (if needed) by utilizing slots and holes nearest the end of the Zee-Bars.

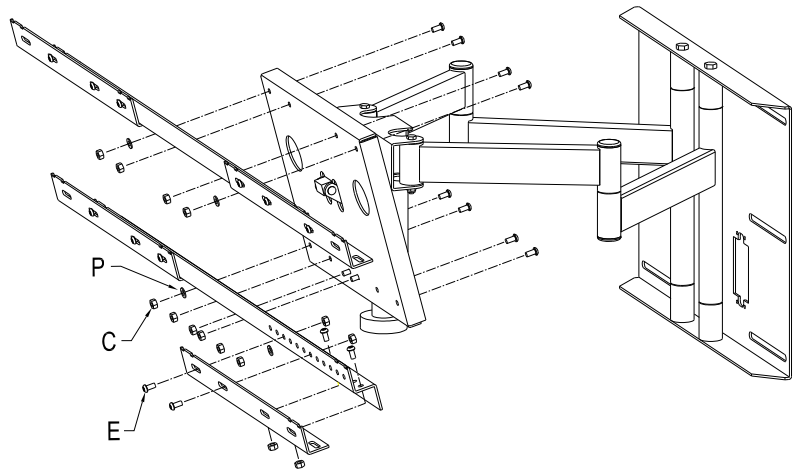

Figure 4

10. Mount the Hanging Brackets to the back of the plasma unit utilizing all of the fastener points recommended by the plasma manufacturer. See Figure 5.

**Note:** It is the responsibility of the installer to obtain any additional fasteners needed to secure the Hanging Brackets to the plasma unit.

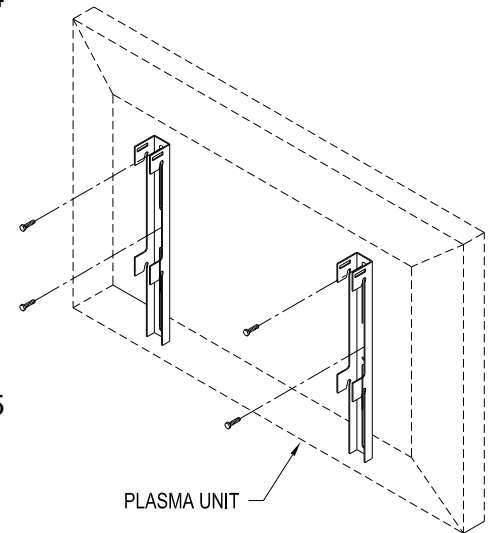

Figure 5

PLASMA UNIT

11. Hang the plasma unit on the wall mount making sure the top and bottom notches on each Hanging Bracket are placed over the upper and lower Zee-Bars. See Figure 6.
12. Attach the Hold-Downs. See Figure 7.

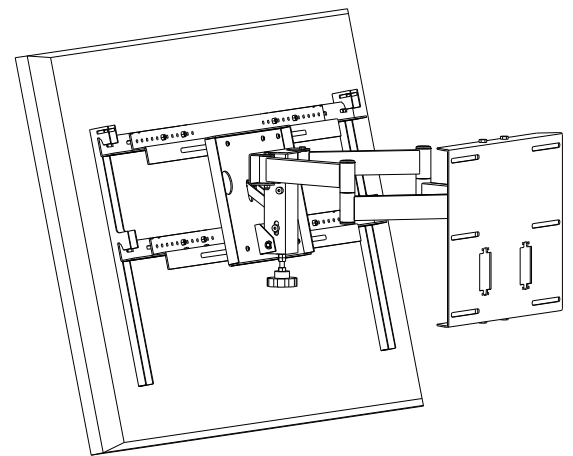

Figure 6

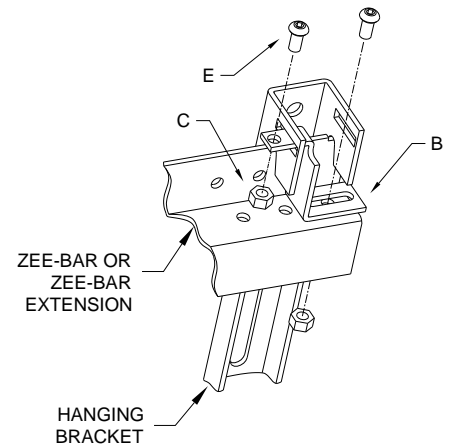

Figure 7

HANGING BRACKET